

# 宗 地 图

XDG-2019-65号A地块

单位: m · m<sup>2</sup>

3486.75-40536.50,  
3486.75-40536.75,  
3487.00-40536.50

320292001212GB00022

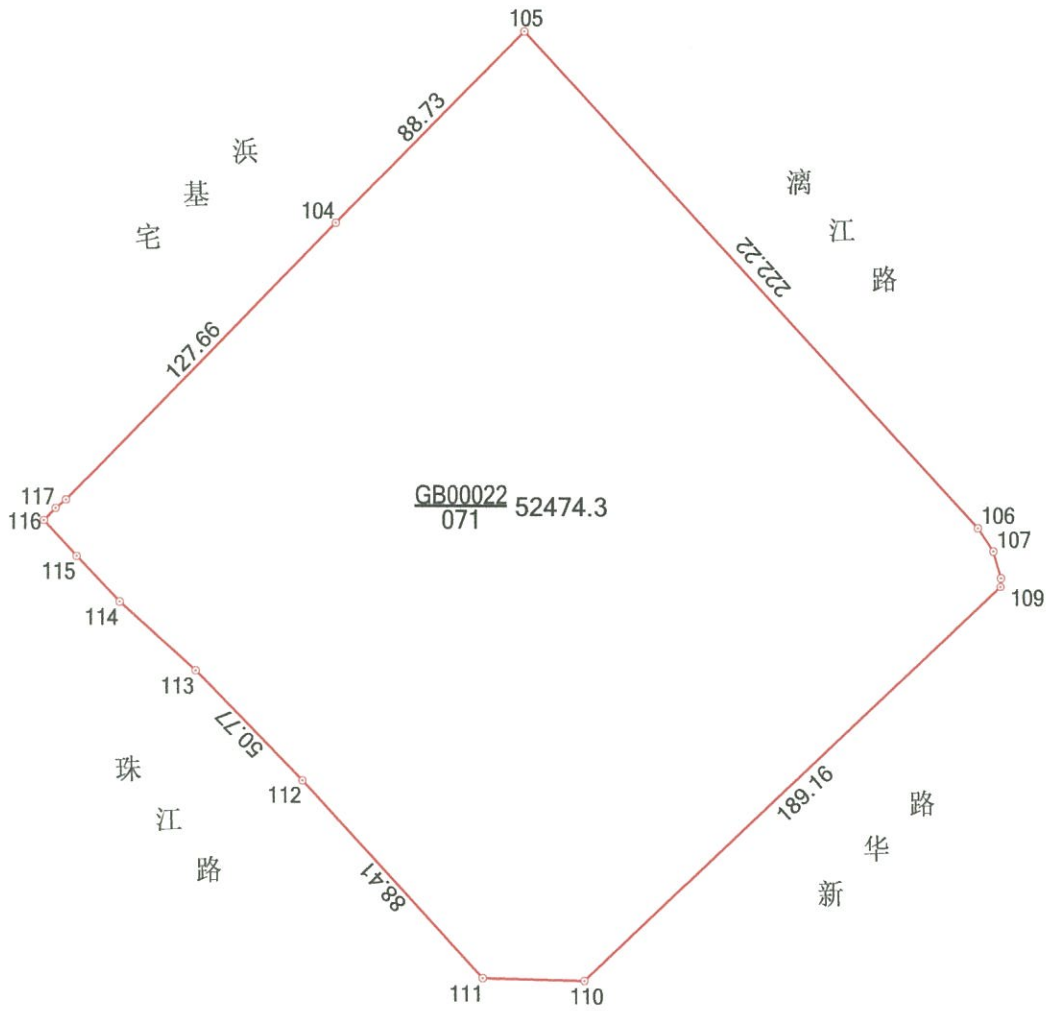

- 106-107: 9.23
- 107-108: 9.23
- 108-109: 2.85
- 110-111: 33.52
- 113-114: 33.81
- 114-115: 20.86
- 115-116: 16.03
- 116-117: 5.59
- 117-118: 4.42



**界址点成果表**      2000坐标

宗地号 320292001212GB00022

宗地面积 (平方米) 52474.3

界址点坐标

顺序号	点号	坐标		边长 (m)	备注
		X (m)	Y (m)		
1	104	3487006.174	40536643.276	88.73	
2	105	3487069.786	40536705.140	222.22	
3	106	3486905.731	40536855.033	9.23	
4	107	3486898.038	40536860.138	9.23	
5	108	3486889.157	40536862.661	2.85	
6	109	3486886.306	40536862.569	189.16	
7	110	3486755.145	40536726.264	33.52	
8	111	3486755.900	40536692.756	88.41	
9	112	3486821.103	40536633.047	50.77	
10	113	3486857.563	40536597.711	33.81	
11	114	3486880.231	40536572.631	20.86	
12	115	3486895.433	40536558.351	16.03	
13	116	3486907.270	40536547.547	5.59	
14	117	3486911.296	40536551.429	4.42	
15	118	3486914.153	40536554.796	127.66	
16	104	3487006.174	40536643.276		

# 宗 地 图

XDG-2019-65号C地块

单位: m · m<sup>2</sup>

3486.25-40536.75,  
3486.25-40537.00,  
3486.50-40536.75

320292001214GB00025

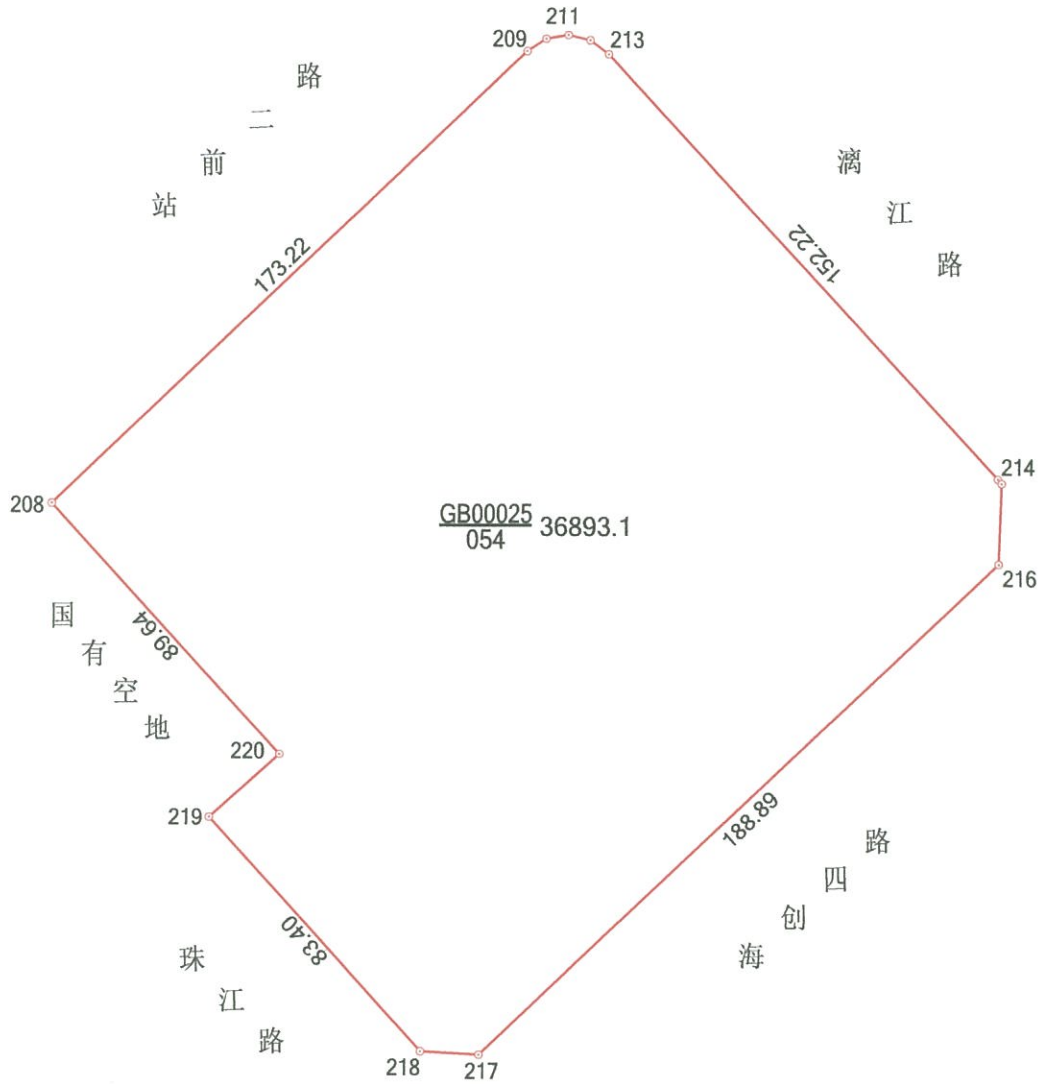

- 209-210: 5.94
- 210-211: 5.94
- 211-212: 5.90
- 212-213: 6.07
- 214-215: 1.52
- 215-216: 21.36
- 217-218: 15.42
- 219-220: 24.92





# 宗 地 图

XDG-2019-65号B地块

单位: m · m<sup>2</sup>

3486.50-40536.75,  
3486.75-40536.75

320292001214GB00024

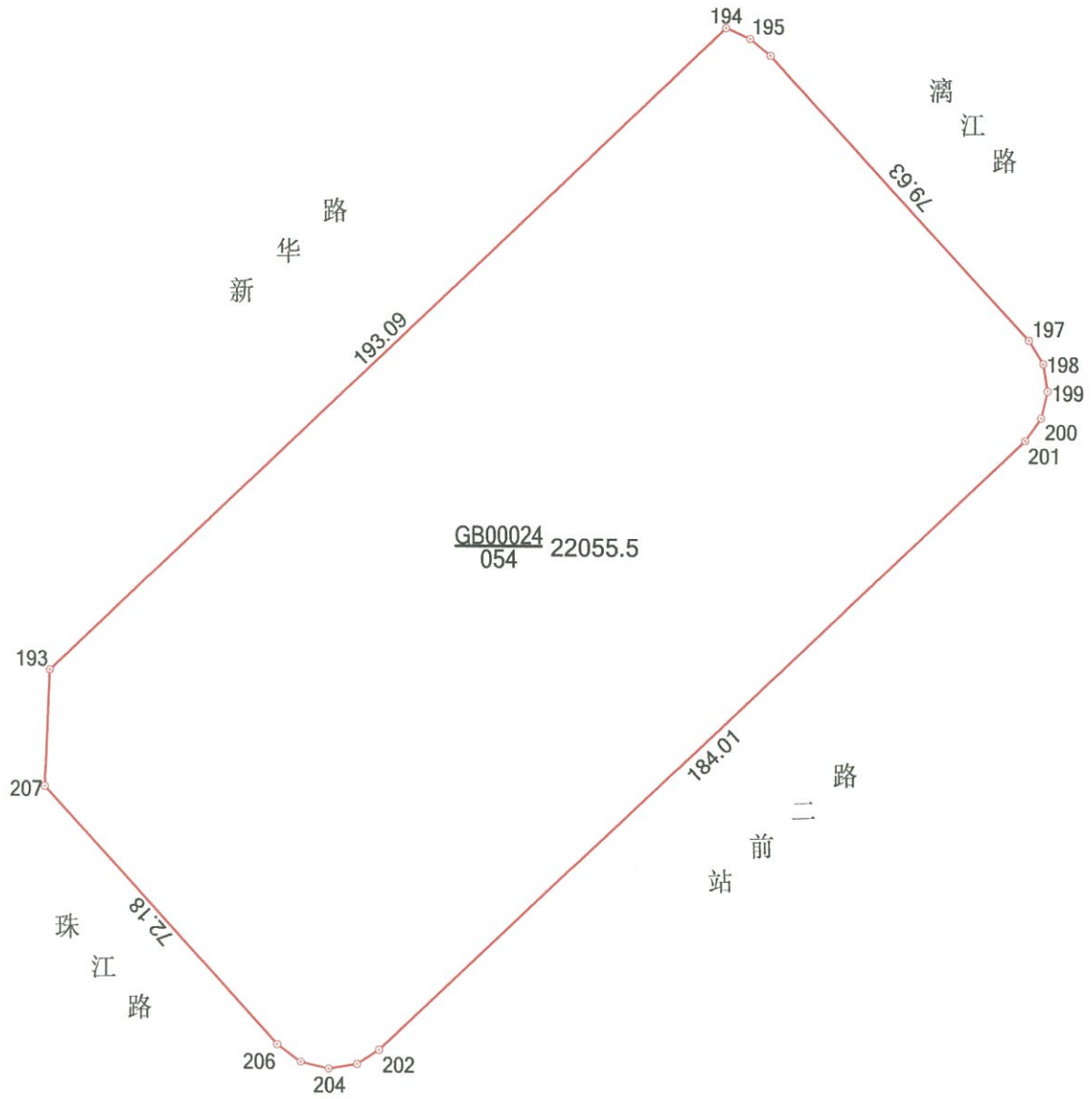

194-195: 5.48	195-196: 5.48
197-198: 5.76	198-199: 5.76
199-200: 5.76	200-201: 5.76
202-203: 5.45	203-204: 5.96
204-205: 5.96	205-206: 5.96
207-193: 24.41	



## 界址点成果表      2000坐标

宗地号 320292001214GB00024

宗地面积 (平方米) 22055.5

### 界址点坐标

顺序号	点号	坐标		边长 (m)	备注
		X (m)	Y (m)		
1	193	3486696.537	40536780.737	193.09	
2	194	3486830.420	40536919.869	5.48	
3	195	3486828.194	40536924.874	5.48	
4	196	3486824.695	40536929.087	79.63	
5	197	3486765.881	40536982.775	5.76	
6	198	3486760.960	40536985.773	5.76	
7	199	3486755.271	40536986.693	5.76	
8	200	3486749.656	40536985.401	5.76	
9	201	3486744.941	40536982.088	184.01	
10	202	3486617.525	40536849.328	5.45	
11	203	3486614.600	40536844.730	5.96	
12	204	3486613.624	40536838.845	5.96	
13	205	3486615.019	40536833.046	5.96	
14	206	3486618.563	40536828.248	72.18	
15	207	3486672.140	40536779.879	24.41	
16	193	3486696.537	40536780.737		